



DELTA

D13.02

Kolon / Guide Pillar

Malzeme - Material : Asil Çelik 1.1213 (Cf 53)
Sertlik - Hardness : 62± 2 HRC
Isıl İşlem - Heat Treatment : İndüksiyon (Induction)
DIN 9833 / ISO 9182-3



Sipariş Kodu	FORD CODE WDX1365	Ø d1	L	L2	L1
D13.02_025140	22025140	25	140	40	4
160	22025160		160		
180	22025180		180		
D13.02_032140	22032140	32	140	45	8
160	22032160		160		
180	22032180		180		
200	22032200		200		
D13.02_040160	22040160	40	160	56	8
180	22040180		180		
200	22040200		200		
224	22040225		225		
250	22040250		250		
D13.02_050160	22050160	50	160	70	10
180	22050180		180		
200	22050200		200		
224	22050225		225		
250	22050250		250		
280	22050280		280		
315	22050315		315		
D13.02_063200	22063200	63	200	80	10
224	22063225		225		
250	22063250		250		
280	22063280		280		
315	22063315		315		
355	22063355		355		
400	22063400	400			
D13.02_080250	22080250	80	250	100	16
280	22080280		280		
315	22080315		315		
355	22080355		355		
400	22080400	400			
D13.02_100315	22100315	100	315	125	16
355	22100355		355		
400	22100400		400		
500	22100500		500		

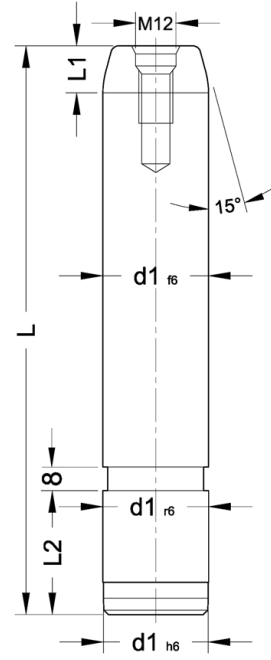

1xM12 Diş Sadece Ø80 ve Ø100

1xM12 Guide Post only Ø80 and Ø100