

Referans Nr.	Sıkma Torku Clamping Stroke	W1	W2	H3	H4	L2	W	L	H2	d	P	H5	L1
2141-00010	1	38	8	6	3	15	45	33.5	10	5.2	36	5	30.5
2141-00015	2	60	12	9	5	22	70	50	15	8.2	55	7	46

Referans Nr.	H	D	H1	R	A	W3	M1	İzin Verilen Tork Allowable Screw Torque (N m)	Sıkma Kuvveti Clamping Force Kgf	(g)
2141-00010	30	13	20	63	12	6	M4x0.7	10	400	85
2141-00015	46	19	30	100	18	10	M5x0.8	27	600	290

Ürün Nr. 2141 Yandan Bağlama

- Gövde**
- Malzeme: Ck45 DIN
 - Siyah kaplama
- Çene**
- Malzeme: 42 CrMo 4 DIN
 - Sertlik: 39-45 HRC
 - Siyah Kaplama

Product Nr. 2141 Side Clamps

- Body**
- Material: Ck45 DIN
 - Black coating
- Jaw**
- Material: 42 CrMo 4 DIN
 - Hardness: 39-45 HRC
 - Black coating

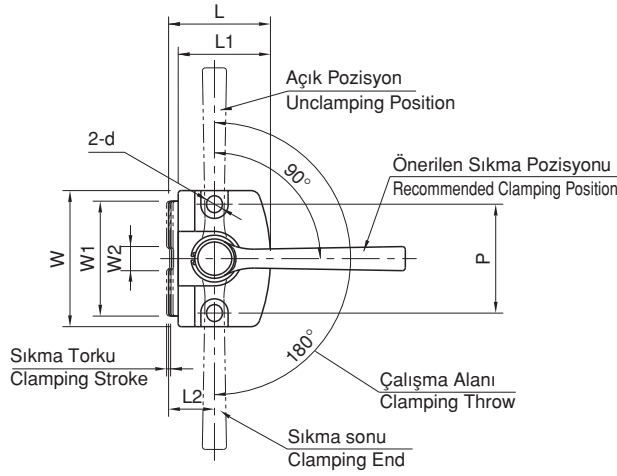

Kullanım Şekli / How To Use

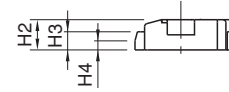
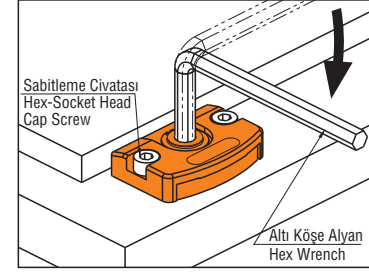

Yandan Bağlama

Referans Nr.	S	W	W1	H1	L1	P	D (h7)	H2	M	L	H	T	Sıkma Kuvveti Clamping Force Kgf	Tork Değeri Allowable Screw Torque (N-m)	(g)
2143-08015	3	25	10	25	21.5	10	6	7	M8	32	15	1.6	700	25	115
2143-10019	4	30	11	32	26	12	6	7	M10	40	19	2	850	50	225
2143-12023	5	35	12	38	33	16	8	10	M12	50	23	2.3	2000	90	390
2143-16025	6	40	14	45	40	20	10	10	M16	60	25	3.2	3000	150	640

Ürün Nr. 2143 Yandan Bağlama

- Malzeme: Ck45 DIN
- Sertlik: 28-32 HRC
- Siyah Kaplama

Product Nr. 2143 Side Clamps

- Material: Ck45 DIN
- Hardness: 28-32 HRC
- Black coating

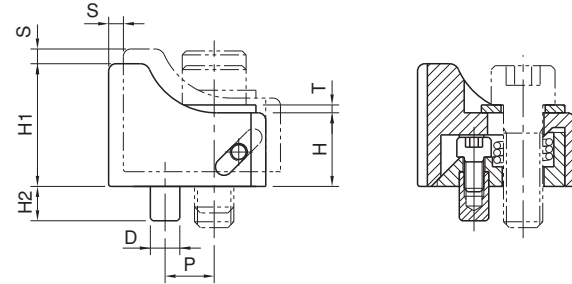

Kurulum ve Kullanım Şekli / How To Use and Install

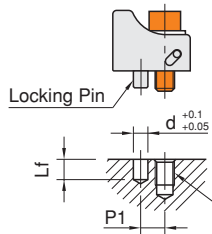

Nr.	M1	d	Lf	P1
CP107-08015	M 8	6	8	10
CP107-10019	M10	8	11	12
CP107-12023	M12	10	14	16
CP107-16025	M16	14	18	20

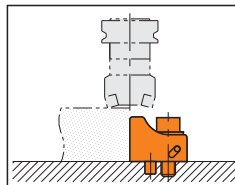

Üst tarafta görüldüğü gibi sabitlemek için bir pim, bir civata deliği gerekli.

Drill a cap-screw hole and a locking-pin hole as specified on the up.

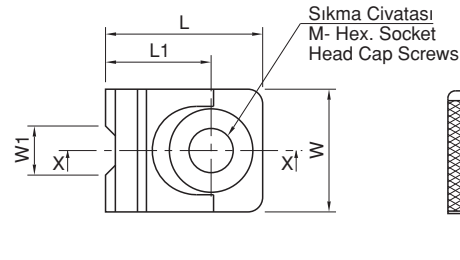

Referans Nr.	s	w	w1	h1	L1	P	d (h7)	h2	M	L	h	t	Sıkma Kuvveti Clamping Force (N)	İzin Verilen Vida Torku Allowable Screw Torque (N•m)	(g)
2144-08015	3	25	10	6	24.5	10	6	7	M8	35	15	1.6	7.000	25	100
2144-10019	4	30	11	8	29	12	6	7	M10	43	19	2	8.500	50	185
2144-12023	5	35	12	9	37	16	8	10	M12	54	23	2.3	20.000	90	320
2144-16025	6	40	14	10	45	20	10	10	M16	65	25	3.2	30.000	150	520

Ürün Nr. 2144 Yandan Bağlama

- Malzeme: Ck45 DIN
- Sertlik: 28-32 HRC
- Siyah kaplama

Product Nr. 2144 Side Clamp

- Material: Ck45 DIN
- Hardness: 28-32 HRC
- Black coating

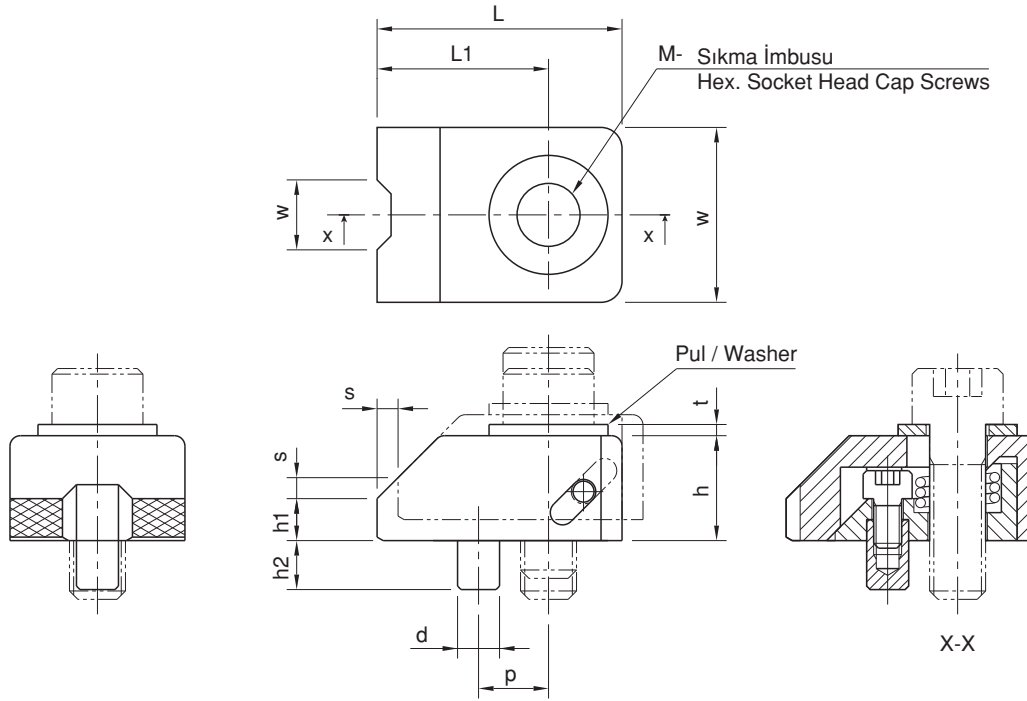

Uygulama Örneği / Application Example

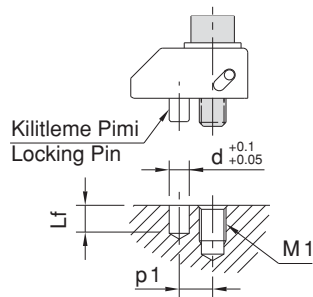

Referans Nr.	M1	d	Lf	p1
2144-08015	M 8	6	8	10
2144-10019	M10	6	8	12
2144-12023	M12	8	11	16
2144-16025	M16	10	11	20

