

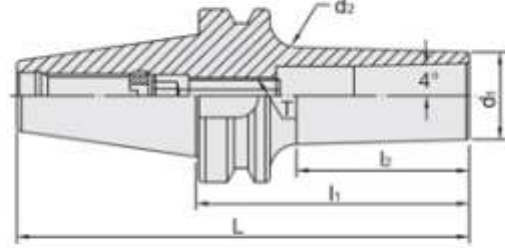

BT İNCE TİP TUTUCULAR



T.W. PAT. NO. M274178

MODEL NO.	TYPE	L	l1	l2	d1	d2	T	WEIGHT (KGS)
25.648.06.070	SBT30 x SBL6 - 70	118.4	38	14	18	ø3 ~ ø6	M6 x 1.0P	0.6
25.648.06.100	SBT30 x SBL6 - 100	148.4	68	14	21	ø3 ~ ø6	M6 x 1.0P	1.25
25.648.12.070	SBT30 x SBL12 - 70	118.4	47	26	33	ø3 ~ ø12	M10 x 1.5P	1.2
25.648.12.100	SBT30 x SBL12 - 100	148.4	77	26	38	ø3 ~ ø12	M10 x 1.5P	1.45
25.648.20.080	SBT30 x SBL20 - 80	128.4	54	34	37	ø3 ~ ø20	M12 x 1.75P	1.2
25.648.20.100	SBT30 x SBL20 - 100	148.4	76	34	39	ø3 ~ ø20	M12 x 1.75P	1.45
26.648.06.070	SBT40 x SBL6 - 70	135.4	28	14	17	ø3 ~ ø6	M6 x 1.0P	1.2
26.648.06.100	SBT40 x SBL6 - 100	165.4	58	14	20	ø3 ~ ø6	M6 x 1.0P	1.6
26.648.12.070	SBT40 x SBL12 - 70	135.4	33	26	31	ø3 ~ ø12	M10 x 1.5P	1.5
26.648.12.100	SBT40 x SBL12 - 100	165.4	63	26		ø3 ~ ø12	M10 x 1.5P	1.7
26.648.20.070	SBT40 x SBL20 - 70	135.4	33	35	38	ø3 ~ ø20	M12 x 1.75P	1.5
26.648.20.100	SBT40 x SBL20 - 100	165.4	68	35	40	ø3 ~ ø20	M12 x 1.75P	1.7
26.648.20.130	SBT40 x SBL20 - 130	195.4	98	35	43	ø3 ~ ø20	M12 x 1.75P	1.74
26.648.25.080	SBT40 x SBL25 - 80	145.4	50.1	40	44.3	ø3 - ø25.4	M16 x 2.0P	1.7
26.648.25.100	SBT40 x SBL25 - 100	165.4	70.1	40	46.1	ø3 - ø25.4	M16 x 2.0P	1.9
27.648.06.070	SBT50 x SBL6 - 70	171.8	17	14	15	ø3 ~ ø6	M6 x 1.0P	4
27.648.06.100	SBT50 x SBL6 - 100	201.8	47	14	19	ø3 ~ ø6	M6 x 1.0P	4.1
27.648.12.070	SBT50 x SBL12 - 70	171.8	22	26	28	ø3 ~ ø12	M10 x 1.5P	4.2
27.648.12.100	SBT50 x SBL12 - 100	201.8	52	26	30	ø3 ~ ø12	M10 x 1.5P	4.3
27.648.12.125	SBT50 x SBL12 - 125	226.8	77	26	32	ø3 ~ ø12	M10 x 1.5P	4.4
27.648.20.070	SBT50 x SBL20 - 70	171.8	22	35	36	ø3 ~ ø20	M12 x 1.75P	4.6
27.648.20.100	SBT50 x SBL20 - 100	201.8	52	35	39	ø3 ~ ø20	M12 x 1.75P	4.7