

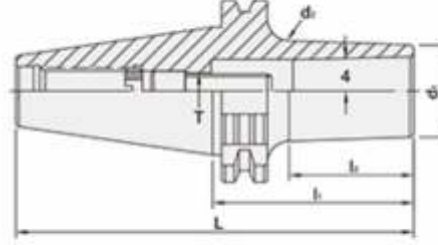

SK İNCE TİP TUTUCULAR



TYPE	T	TORQUE	
		N.m	1bf-ft
SBL6	M6 x 1.0P	12	9
SBL12	M10 x 1.5P	59	43
SBL20	M12 x 1.75P	100	74

MODEL NO.	TYPE - I1	L	l2	d1	d2	T	SIZE RANGE	WEIGHT (KGS)
SYIC - 45352	DAT30 x SBL6 - 70	117.8	41	14	18	M6 x 1.0P	3.0 ~ 6.0	0.39
SYIC - 45354	DAT30 x SBL6 - 100	147.8	71	14	21	M6 x 1.0P	3.0 ~ 6.0	0.4
SYIC - 45356	DAT30 x SBL12 - 70	117.8	48	26	31	M10 x 1.5P	3.0 ~ 12	0.42
SYIC - 45358	DAT30 x SBL12 - 100	147.8	78	26	34	M10 x 1.5P	3.0 ~ 12	0.43
SYIC - 45362	DAT30 x SBL20 - 80	127.8	58	34	38	M12 x 1.75P	3.0 ~ 20	0.44
SYIC - 45364	DAT30 x SBL20 - 100	147.8	79	34	39	M12 x 1.75P	3.0 ~ 20	0.45
SYIC - 45368	DAT40 x SBL6 - 70	138.4	36	14	17	M6 x 1.0P	3.0 ~ 6.0	1
SYIC - 45370	DAT40 x SBL6 - 100	168.4	58	14	20	M6 x 1.0P	3.0 ~ 6.0	1.1
SYIC - 45372	DAT40 x SBL12 - 70	138.4	41	26	29	M10 x 1.5P	3.0 ~ 12	1.2
SYIC - 45374	DAT40 x SBL12 - 100	168.4	71	26	32	M10 x 1.5P	3.0 ~ 12	1.3
SYIC - 45374-170	DAT40 x SBL12 - 170	238.4	146	26	38	M10 x 1.5P	3.0 ~ 12	2
SYIC - 45376	DAT40 x SBL20 - 70	138.4	41	35	38	M12 x 1.75P	3.0 ~ 20	1.3
SYIC - 45378	DAT40 x SBL20 - 100	168.4	78	35	41	M12 x 1.75P	3.0 ~ 20	1.4
SYIC - 45379	DAT40 x SBL25 - 80	148.4	58	40	45	M16 x 2.0P	3.0 ~ 25	1.5
SYIC - 45379-100	DAT40 x SBL25 - 100	168.4	79	40	46	M16 x 2.0P	3.0 ~ 25	1.6
SYIC - 45380	DAT50 x SBL6 - 70	171.75	36	14	17	M6 x 1.0P	3.0 ~ 6.0	2.8
SYIC - 45382	DAT50 x SBL6 - 100	201.75	66	14	20	M6 x 1.0P	3.0 ~ 6.0	2.9
SYIC - 45384	DAT50 x SBL12 - 70	171.75	41	26	29	M10 x 1.5P	3.0 ~ 12	3
SYIC - 45386	DAT50 x SBL12 - 100	201.75	71	26	32	M10 x 1.5P	3.0 ~ 12	3.1
SYIC - 45388	DAT50 x SBL20 - 70	171.75	41	35	38	M12 x 1.75P	3.0 ~ 20	3.2
SYIC - 45390	DAT50 x SBL20 - 100	201.75	71	35	41	M12 x 1.75P	3.0 ~ 20	3.3
SYIC - 45391	DAT50 x SBL20 - 170	271.75	139	40	47	M12 x 1.75P	3.0 ~ 20	3.9
SYIC - 45392	DAT50 x SBL25 - 70	171.75	39	40	43	M16 x 2.0P	3.0 ~ 25	3.2
SYIC - 45394	DAT50 x SBL25 - 100	201.75	71	40	46	M16 x 2.0P	3.0 ~ 25	3.4