

1108

1/2" 6 Köşe Havalı Derin Lokma Anahtar (mm)  
6 Point Impact Socket Wrench, Long Type (mm)

3

YENİ  
NEW



1/2"

Krom molibden, Fosfat kaplamalı  
Chrom molybdenum, Phosphate finish

KOD CODE	mm	L mm	g	TL/Ad.
1108 06 7010	10	80	136	10 20,08
1108 06 7011	11	80	144	10 20,08
1108 06 7012	12	80	157	10 20,08
1108 06 7013	13	80	157	10 20,08
1108 06 7014	14	80	172	10 20,08
1108 06 7015	15	80	223	10 24,36
1108 06 7016	16	80	230	10 24,36
1108 06 7017	17	80	240	10 24,36
1108 06 7018	18	80	255	10 24,36
1108 06 7019	19	80	236	10 24,36
1108 06 7021	21	80	240	10 25,39
1108 06 7022	22	80	296	5 25,39
1108 06 7024	24	80	308	5 26,87
1108 06 7027	27	80	356	5 35,58
1108 06 7030	30	80	416	5 39,86
1108 06 7032	32	80	510	5 42,52

1113

1/2" Altı Köşe Lokma Anahtar (mm)  
Socket Wrench 6 Points (mm)

TS ISO 2725 -1



1/2"

Krom vanadyum, Krom kaplı  
Chrom vanadium, Chrom plated,

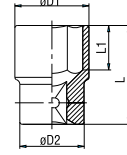

KOD CODE	mm	ø D1 mm	ø D2 mm	L mm	L1 mm	g	TL/Ad.
1113 06 1008	8	13.2	21.8	38	7	55	10 9,00
1113 06 1009	9	14	21.8	38	7	55	10 9,00
1113 06 1010	10	15	23.3	38	8	55	10 14,92
1113 06 1011	11	16.4	23.3	38	8	60	10 14,92
1113 06 1012	12	17.8	23.3	38	9	60	10 14,92
1113 06 1013	13	19	23.3	38	10	65	10 16,04
1113 06 1014	14	20.4	23.3	38	11	65	10 16,04
1113 06 1015	15	21.6	23.3	38	11	65	10 16,04
1113 06 1016	16	22.9	24	38	11	70	10 16,79
1113 06 1017	17	24	22.5	38	12	70	10 16,79
1113 06 1018	18	25.2	23	38	13	75	10 16,79
1113 06 1019	19	26.8	23	38	13	75	10 17,52
1113 06 1020	20	28	23	38	13	80	10 17,52
1113 06 1021	21	29.2	23	38	13	85	5 17,52
1113 06 1022	22	30.2	24	40	15	95	5 17,52
1113 06 1023	23	31.4	25	40	15	100	5 18,28
1113 06 1024	24	32.6	26	42	17	115	5 18,28
1113 06 1025	25	34	27	42	17	125	5 18,28
1113 06 1026	26	35.3	28	42	17	135	5 18,28
1113 06 1027	27	36.6	28	42	19	140	5 20,97
1113 06 1028	28	37.8	30	42	20	160	5 20,97
1113 06 1029	29	39	30	44	21	170	5 20,97
1113 06 1030	30	40	29.5	44	21	180	5 20,97
1113 06 1032	32	42.5	30	44	23	190	5 20,97



(\*) İşaretili olan ürünler stoklarla sınırlıdır.