

E Turbo Mill

PES2000/3000/4000



2000/3000 Tip

4000 Tip

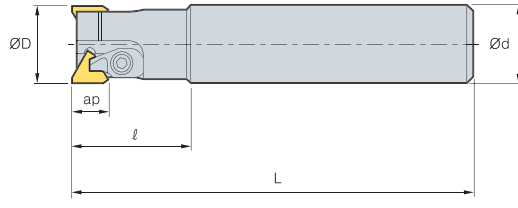

Şekil 1

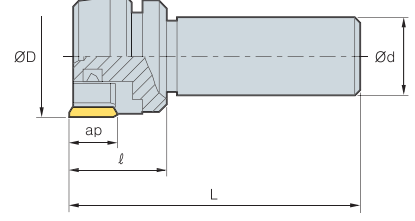

Şekil 2

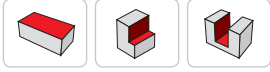
AA
90°

• AR: 10°~15°
• RR: 2°~3°

(mm)

Kod		ØD	Ød	ℓ	L	ap	$\frac{kg}{m}$	Şekil	
PES	2020R	2	20	20	30	110	8	0.3	1
	2025R	2	25	25	35	120	8	0.5	1
PES	3030R	2	30	32	45	160	13	0.9	1
	3032R	2	32	32	45	160	13	1.0	1
	3033R	2	33	32	45	160	13	1.1	1
	3035R	2	35	32	45	160	13	1.2	1
	3036R	2	36	32	45	160	13	1.3	1
	3040R	2	40	32	45	160	13	1.4	1
	PES	4050R	3	50	32	40	120	16.5	1.2
4050R-S42		3	50	42	40	120	16.5	1.5	2
4063R		4	63	32	40	120	16.5	1.5	2
4063R-S42		4	63	42	40	120	16.5	1.8	2

➤ Kullanılabilir Kesici Uçları

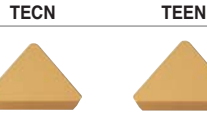

Kod	Sermet	Kaplama										Sayfa						
		CN2000	CN30	NCM325	NCM335	NC5330	NC5340	NC5350	PC3500	PC3600	PC9530		PC5300	PC5400	ST30A	G10	H01	
2000 Tip	TECN	22R																E26
		22TR	●															
3000 Tip	TECN	32R																E26
		32TR	●	●														
		32TR-S20																
4000 Tip	TEEN	43R																E26
		43R-G																
		43TR	●	●	●	●												
		43TR-S20																
		43TR-Z																
		43TR-ZH																

➤ Önerilen Kesme Koşulu

İş parçası	Kesme Koşulu		Kaliteler
	vc (m/dak)	fz (mm/diş)	
P	190~320	0.05~0.20	NCM325 PC3500 ST30A
	161~270	0.05~0.20	
	80~140	0.05~0.20	
M	90~150	0.05~0.20	PC9530
K	140~230	0.05~0.30	PC6510 G10
	50~90	0.05~0.30	

Montaj

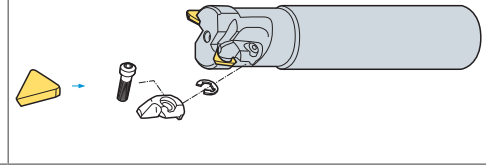

➤ Yedek Parçalar

Ölçü	Tespit Parçası	Baskı	Baskı Vidası	Tespit Parça Vidası	Anahtar	Anahtar	Clamp	Ring
Ø20~Ø25 (2000 Tip)	-	-	-	CHX0407	HW25L	-	CH4R1	ER03
Ø30~Ø40 (3000 Tip)	-	-	-	CHX0510	HW30L	-	CH5R1	ER04
Ø50~Ø63 (4000 Tip)	LPTS4R/L	WPTSR	DHA0815	LTX0512	-	HW40	-	-

➤ Kullanılabilir Kesici Uçları E26



E Frezeleme

56